

For Sale
By Formal Tender
12.00pm (Midday), Friday 5th December 2025

Development Site
c. 23.08 acres / c.9.34 hectares
Lehenaghmore,
Co Cork

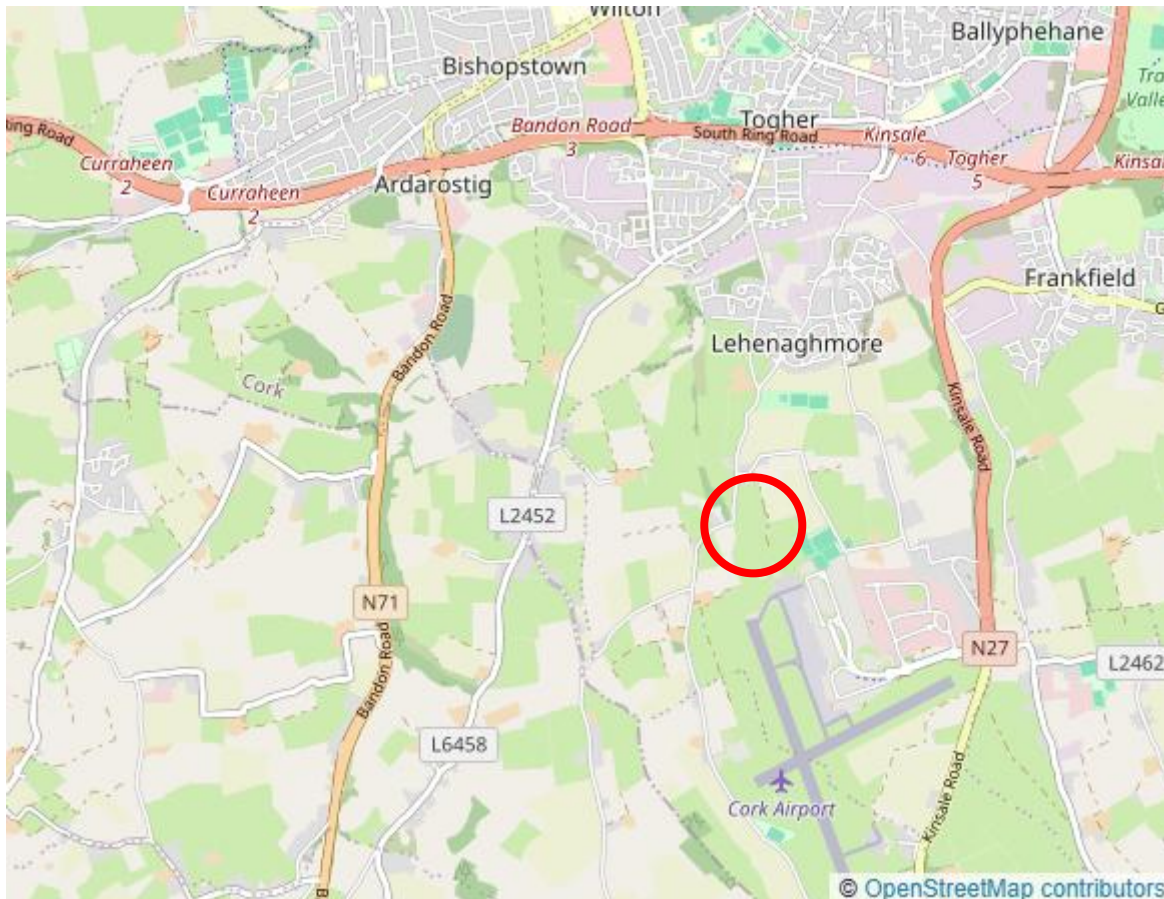

Photo for general location identification purposes only

Situated on the on the southern side of Cork city this site represents an excellent opportunity to acquire a strategic site bounding Cork Airport. Currently in Agricultural use the entirety of the parcel lies within an area Zoned “Cork Airport Infrastructure” in the current City Development plan. The property is easily accessed from both the Togher Road and the Pouladuff Road via Lehenaghmore.

Location

Within easy access of the southern suburbs the property is accessed from the south ring road by taking the Togher exit coming from the Kinsale Road Roundabout and taking the Lehenaghmore Exit off the roundabout on the Pouladuff Road. Continue on straight up the hill passing manor Farm, Matthew Hill and Lehenaghmore Park. The land is on the left hand side of the road before the sharp turn to the right.



Description

The property comprises a c.23 acre potential development site which is currently in agricultural use. The land in general slopes gently down from its Eastern boundary to its Western boundary. It is bounded by a mix of agricultural users, a local soccer club as well as Cork Airport to the South.



DISCLAIMER: Irish & European & Denis Barrett Auctions, for themselves and for the vendor/lessor whose agents they are, give notice that above particulars are given on the strict understanding that all negotiations shall be conducted through this firm. The particulars are produced in good faith, are set out as a general guide only and do not constitute any part of a contract. Every care has been taken in their preparation, but we do not hold ourselves responsible for any inaccuracies. Intending purchasers / lessees must satisfy themselves as to the accuracy of the details given to them either verbally or as part of this brochure. No person in the employment of Irish & European has authority to make or give any representation or warranty whatever in relation to this property. Prices quoted are exclusive of VAT (unless otherwise stated) and all negotiations are conducted on the basis that the purchasers/lessees shall be liable for any VAT arising on the transaction. All maps are produced by permission of the Ordnance Survey Ireland Licence No. AU 0023013

DISCLAIMER: Irish & European & Denis Barrett Auctions, for themselves and for the vendor/lessor whose agents they are, give notice that above particulars are given on the strict understanding that all negotiations shall be conducted through this firm. The particulars are produced in good faith, are set out as a general guide only and do not constitute any part of a contract. Every care has been taken in their preparation, but we do not hold ourselves responsible for any inaccuracies. Intending purchasers / lessees must satisfy themselves as to the accuracy of the details given to them either verbally or as part of this brochure. No person in the employment of Irish & European has authority to make or give any representation or warranty whatever in relation to this property. Prices quoted are exclusive of VAT (unless otherwise stated) and all negotiations are conducted on the basis that the purchasers/lessees shall be liable for any VAT arising on the transaction. All maps are produced by permission of the Ordnance Survey Ireland Licence No. AU 0023013

Land Registry Compliant Map



CENTRE COORDINATES:
ITM 569897.509881

PUBLISHED:
23/09/2025

ORDER NO.:
50492091_1

MAP SERIES:
6427-A
6427-B
6427-D
6469-A
6469-B

MAP SHEETS:
12,500
12,500
12,500
12,500
12,500

COMPILED AND PUBLISHED BY:
Tailte Éireann,
Phoenix Park,
Dublin 8,
Ireland
D08F6E4

www.tailte.ie

Any unauthorised reproduction, in whole or in part, of this publication, or any part of it, is prohibited. No part of this publication may be copied, reproduced or transmitted in any form or by any means without the prior written permission of the copyright owner.

The representation on this map of a road, track or footpath is not evidence of the existence of a right of way.

This topographic map does not show legal property boundaries, nor does it show ownership of physical features.

©Tailte Éireann, 2025
All rights reserved.

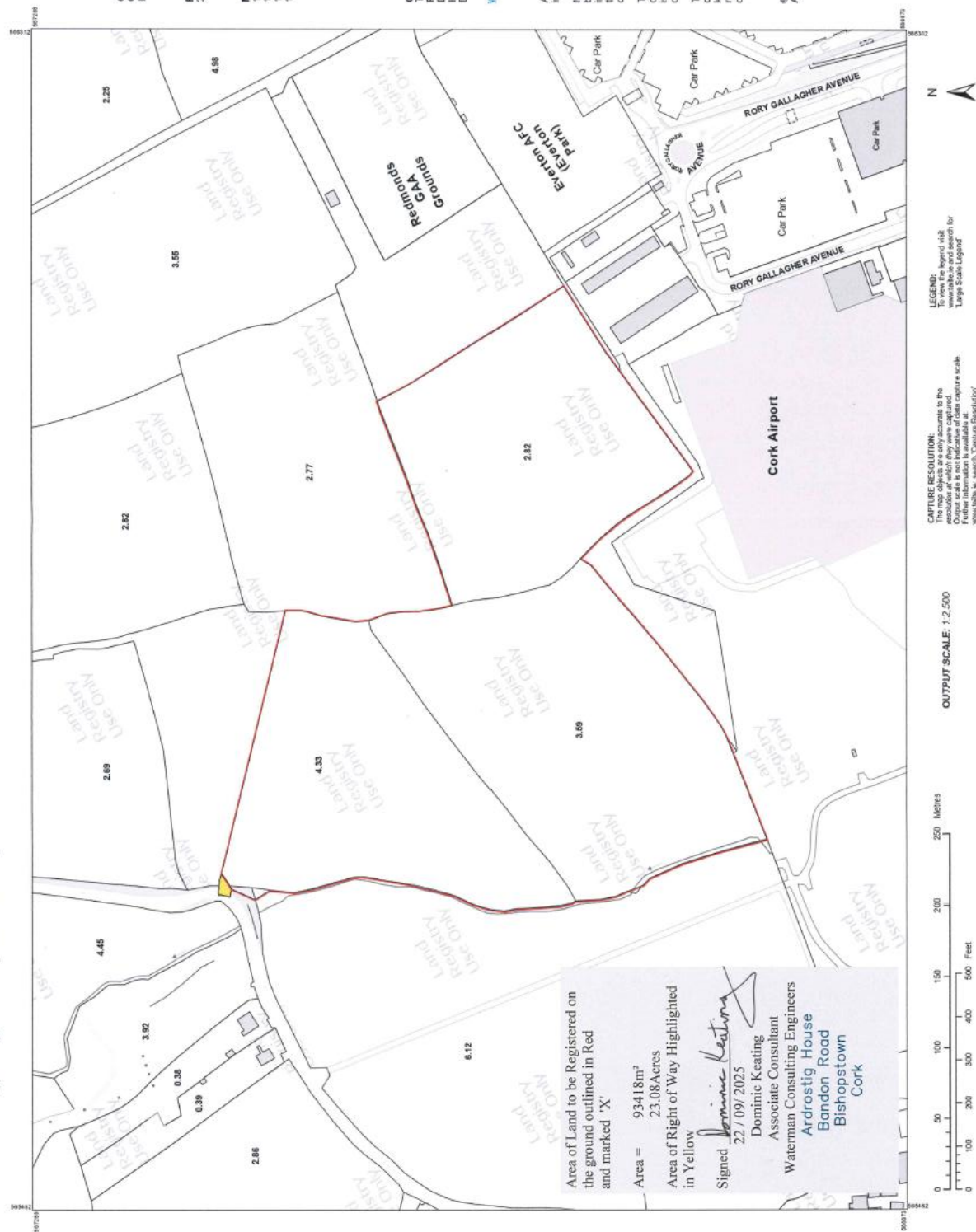

DISCLAIMER: Irish & European & Denis Barrett Auctions, for themselves and for the vendor/lessor whose agents they are, give notice that above particulars are given on the strict understanding that all negotiations shall be conducted through this firm. The particulars are produced in good faith, are set out as a general guide only and do not constitute any part of a contract. Every care has been taken in their preparation, but we do not hold ourselves responsible for any inaccuracies. Intending purchasers / lessees must satisfy themselves as to the accuracy of the details given to them either verbally or as part of this brochure. No person in the employment of Irish & European has authority to make or give any representation or warranty whatever in relation to this property. Prices quoted are exclusive of VAT (unless otherwise stated) and all negotiations are conducted on the basis that the purchasers/lessees shall be liable for any VAT arising on the transaction. All maps are produced by permission of the Ordnance Survey Ireland Licence No. AU 0023013

Services: Mains water available

Title: We understand that the property is held freehold.

Solicitor: Colm O Rourke,
Ahern Roberts O Rourke Williams & Partners
The Old Rectory, Cork Rd, Carrigaline, Co. Cork, P43 W921

Tender: **Tender Documents are available from and are to be submitted to:**

**Colm O Rourke,
Ahern Roberts O Rourke Williams & Partners
The Old Rectory, Cork Rd, Carrigaline, Co. Cork, P43 W921**

**Tenders are to be submitted by:
12.00pm (Midday), Friday 5th December 2025**

Further details available from Joint Agents:



Denis Barrett
Denis Barrett Auctions
The Laurels, Lehenaghmore,
Togher, Cork
Email: info@denisbarrett.com
Tel: 00 353 86 4019848
PRSA Licence No: 004784

Trevor Mc Carthy
Irish & European Cork Ltd
23 South Mall, Cork
Email: Trevor@irishanduropean.ie
Tel: 021 4277606
PSRA Licence No: 001105